

NOTICE

- ① A Micro SIM Card needed , do not support CDMA2000 ;

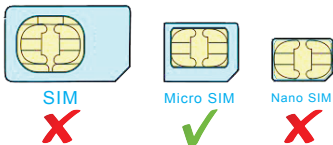

- ② GPRS & Call ID of Sim Card must be opened ;
Traffic, SMS, Calls and other SIM card service fee charged by operators;
- ③ Positioning / Remote Power off / Remote command function rely on the network of base station. Device may not work well if the network signal is not very good;
- ④ Product should stay away from fire, high temperature, heat and other extreme environments;
- ⑤ Product should not be soaked or rinsed in water;

INTRODUCTION

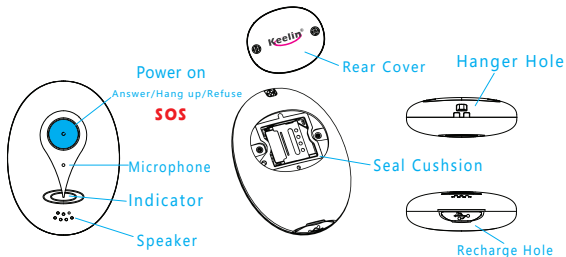

- **Power button** : Press >3s to power on (No power off button, use app to power off)
- **Answer/Hang up/Refuse** : If there is an incoming call from guardian number which can be set at app(Call form non-guardian will be rejected), short press to get through and long press to reject, It will get through automatically in 40s if no answer. Short press to hang up if get through already.
- **SOS** : Press >3s to call guardian number and send SOS alarm to web platform and APP.



GPS/WiFi (Satellite/WiFi signal,Blue)
Quick flash: Searching for GPS
Satellite/WiFi signals (Not positioned);
Slow flash: Found GPS/WiFi signals ;
(Positioned by GPS/WiFi)
Blue LED Long light after charging.



GSM LED (LBS / Base signal, Red)
Quick flash: Searching for base signals
(Not connect yet) ;
Slow flash: Found base signals ;
(Base Connected and LBS start)
Red LED Long light when charging.

Function/Parameter

- GPS/WiFi/LBS triple-Positioning mode, intelligent switching
- A variety of wearing styles, suitable for the elderly, children, pets
- IP65 waterproof
- 2-ways communication ,conversation and listening
- Emergency SOS for help
- Real-time tracking on Platform & APP ,playback track in 90 days
- Receive SOS alarm, fence alarm, low battery alarm on APP
- Built-in pedometer, amount of movement shows on APP

GPS Positioning Accuracy	5-15m (Depend GPS signal)
LBS Positioning Accuracy	About 200m (Depend Bases Density)
WiFi Positioning Accuracy	5-50m (Depend Hot Spots Density)
GPS Frequency	1575 MHz
GSM Frequency	850/900/1800/1900 MHz
Hot/Warm/Cold Start Time	<3秒, <15秒, <60秒
Battery Capacity	420 mAh
Dimensions (mm)	55(L)×40(W)×14.3(H)
Temperature/Humidity	-20°C~65°C / 20%~80%RH
Weight	20 g

Q & A

Q : Positioned by GPS / WiFi / LBS ?

A : GPS called "Global Positioning System" ,GPS device can be positioned by GPS satellite outdoor. Device with Wifi module positioned by WiFi hot spot nearby for assistance indoor-positioning. Device also can be positioned by base station of operator which call LBS ,mainly for assistance positioning.

Q : Location is not accurate?

A : If need accurate positioning, use device outdoor where GPS signal is good and start GPS tracking mode.

Device indoor mainly positioned by LBS & WiFi, the accuracy lower than GPS

Q : Standby time can be longer?

A : Device need Internet connection. Standby time will be different by different using environment and working mode.

Q : Device offline?

A : The conditions below results in offline.

- ① No balance or No SIM
- ② No GSM or GSM signal is weak
- ③ Battery runs out

Attention for more services:



Wechat Official Account



Keelin Mall



QQ Group of Keelin Users

e²Link Wearable GPS Tracker

EELINK Communication Technology CO.LTD

Address: 3 Floor, Yu yang mansion, 2nd Road of Langshan,
Science and Technology Park, Nanshan District, ShenZhen, CHINA

TEL : 0755-86278376 / 86278370

Mail : Sales@eelink.com.cn

1 Check Accessory, Insert SIM, Charge & Boot

- Complete Accessories include charger, USB cable, silicone sets, manual, lanyard, screwdriver, screws.
- Open **Rear Cover**, insert Micro SIM card.

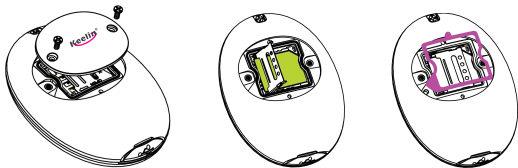

- Do not move **Seal cushion**, tighten screws on **Rear Cover**.
- Connect USB charger, Automatic boot, blue LED always on after fully charged.

▶▶ Begin experience of GPS tracker

2

Install KEELIN APP, Activate device

- Scan QR below to download Keelin APP



- Launch APP , Scan QR on Label to register & activate device



▶▶▶ Begin experience of Keelin APP

Keelin[®]
可依恋

Guardian Genius



K30 Quick Start Guide

